

합성목재 난간 'KDFU94-35' (W:1500*H:1200)

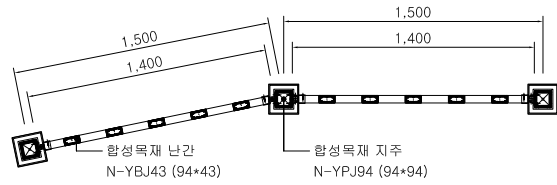

난간 평면도

SCALE = 1/15(A1), 1/30(A3)

No	품명	규격	단위	수량	인용규격
①	지주 - 보강재	아연도금관 (75*75*2.3T)	m	1.2	KSD3568 중 SPSR400
②	지주 - 마감재	N-YPJ94 (94*94)	m	1.2	KSF3230
③	난간 - 보강재	KFB-NY43 (76*25*1T)	m	6.5	KSD3506 중 SGCC(Z12)
④	난간 - 마감재	N-YBJ43 (94*43)	m	6.5	KSF3230
⑤	지주캡 - AL	KFB-J94 (103*103)	ea	1	KS D 2331 (ALDC12.1)
⑥	하부캡 - AL	KFB-H94 (174*174)	ea	1	KS D 2331 (ALDC12.1)
⑦	연결캡 - 유동형 AL	KFB-UB43 (103*51*65)	ea	6	KS D 2331 (ALDC12.1)
⑧	U형앵글	KFB-U23 (52*23*30)	ea	10	KS D 3698(STS 304)

난간 물량표 (경간당)

SCALE = NONE

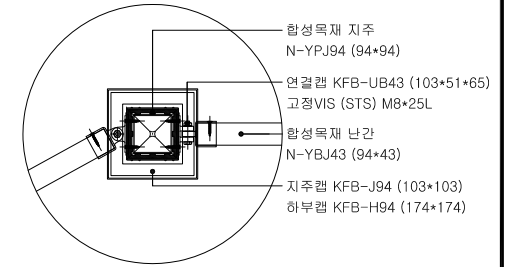

난간 평면 상세도

SCALE = 1/5(A1), 1/10(A3)

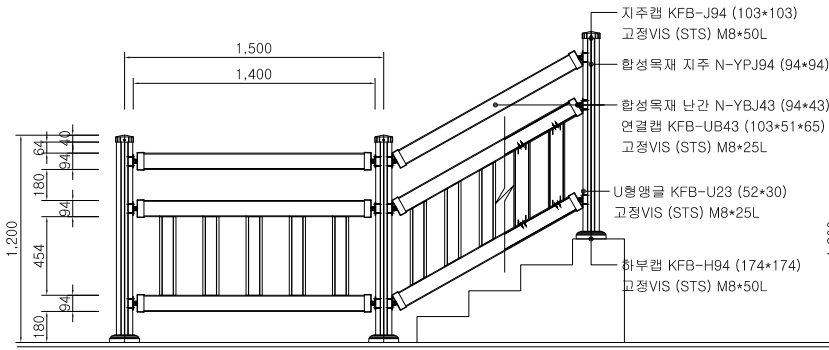

난간 입면도

SCALE = 1/15(A1), 1/30(A3)

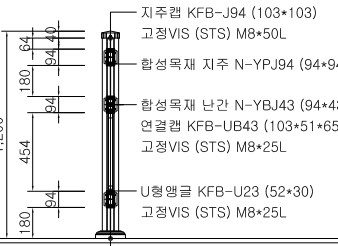

난간 단면도

SCALE = 1/15(A1), 1/30(A3)

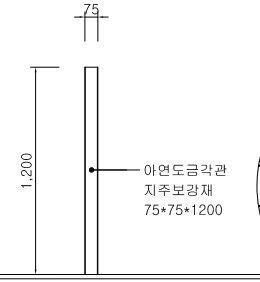

지주 보강재 상세도

SCALE = 1/15(A1), 1/30(A3)

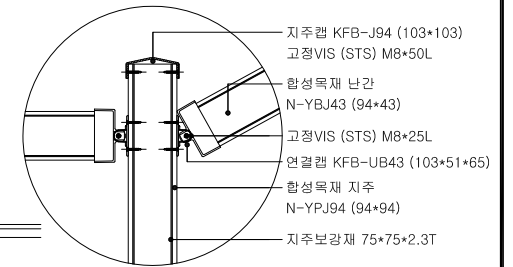

난간 입면 상세도

SCALE = 1/5(A1), 1/10(A3)

②	①	M8*50L	⑤	⑥	⑦	⑧
94*94*6~9T	75*75*2.3T	지주, 하부캡 고정VIS	103*103*40	174*174*44	103*51*65	52*23*30*1.2T
N-YPJ94 : 지주재	지주보강재		KFB-J94 : 지주캡	KFB-H94 : 하부캡	KFB-UB43 : 연결캡	KFB-U23 : U형앵글
94*43*7T	76*25*1T	M8*25L	103*103*40	174*174*44	103*51*65	52*23*30*1.2T
N-YBJ43 : 난간재	KFB-NY43 : 보강재	연결캡 고정VIS				

부자재상세도

SCALE = 1/5(A1), 1/10(A3)

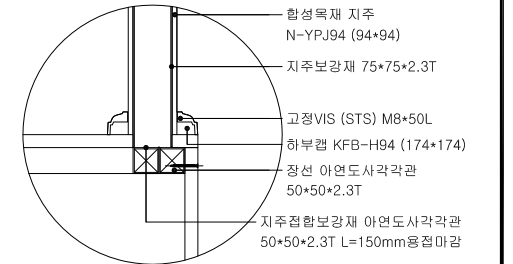

하부 접합 상세도

SCALE = 1/5(A1), 1/10(A3)